

Premium A2 Booth 5mW x 3mD One side open

OP-A2-15
5mW x 3mD x 3.25mH

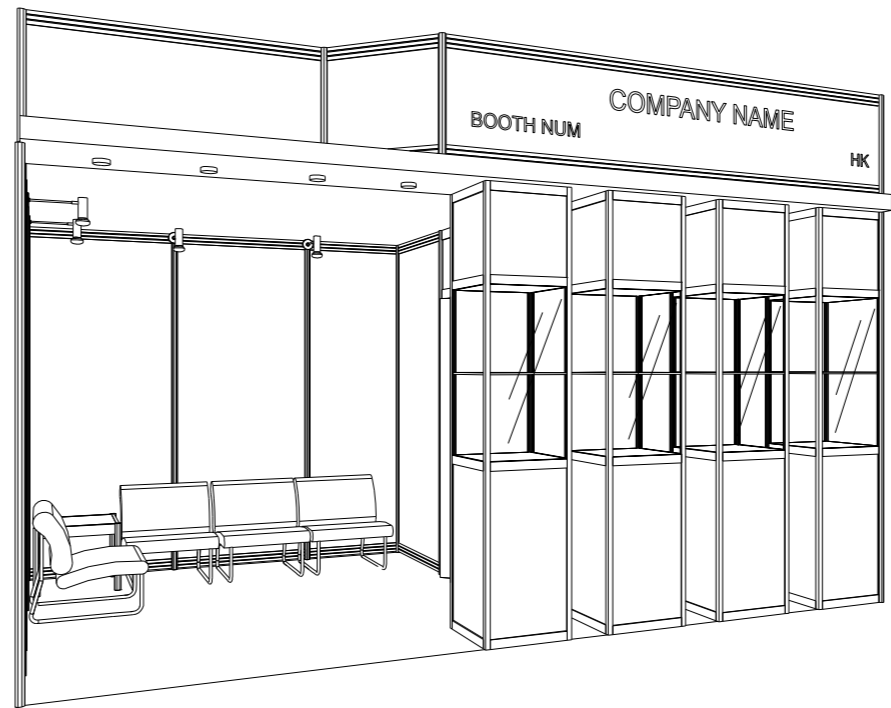
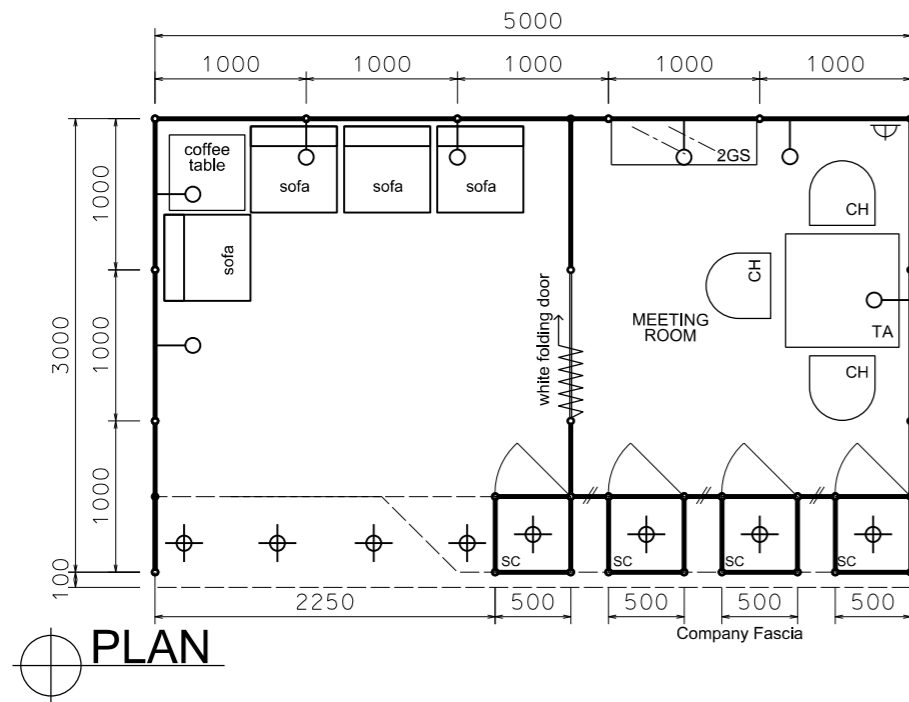

PERSPECTIVE N.T.S.

BOOTH SPECIFICATION		QTY
	Front showcase with 1 layer glass shelf ,swing door and 7W LED downlight (0.5mW x 0.5mD x 2.5m H)	4
	Glass shelf (flat) (1mL x 0.3mD)	2
	White folding door (1mL x 2mH)	1
	Coffee table (0.5m x 0.5m)	1
	Sofa	4
	Square meeting table (0.7m X0.7m x 0.75mH)	1
	Black leather chair	3
	Longarmed spotlight w/13 watt LED lamp (yellow)	7
	500w Square pin power socket	1
	7W LED downlight	4

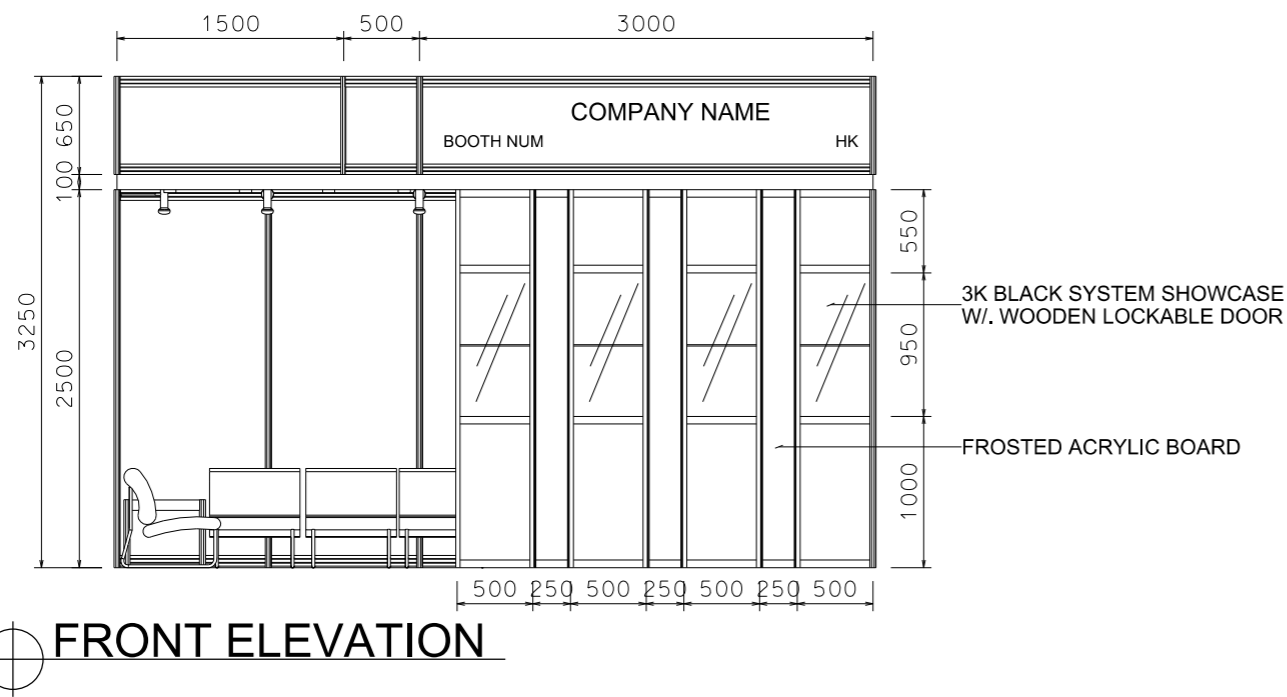

FRONT ELEVATION

FILE PATH - L:\Local Fair Premium Booth 2011\OP-A-Layout\OP-A-2dLayout_NEW.dgn

	NOTES UNLESS OTHERWISE SPECIFIED ALL DIMENSIONS ARE IN MM.	REVISION 04-09-2017 . 02-04-2019	DATE: 02-04-2019	TITLE Premium Booth OP-A2-15	PROJECT PREMIUM BOOTH A2 5m x 3m DATE: XXXXXXXX	SHEET OP-A103
			SCALE: 1 : 50 (A3)			