

Premium Booth 4mW x 3mD One side open

OP-B-12
4mW x 3mD x 3.5mH

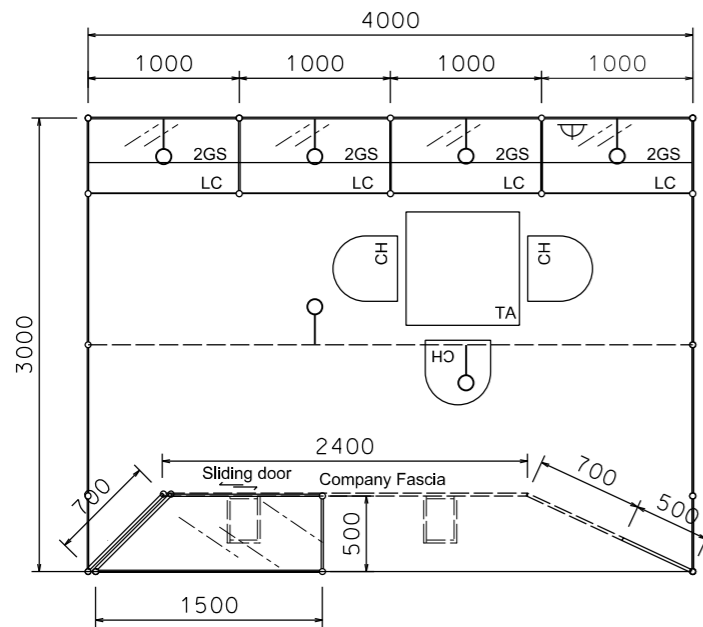

PLAN

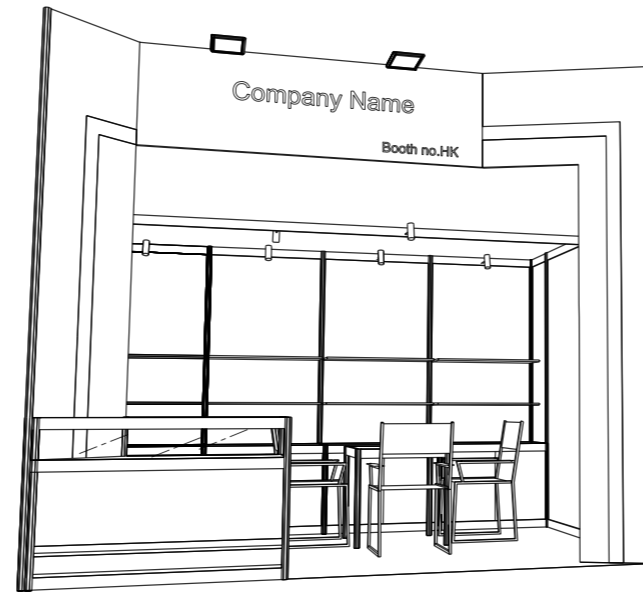

PERSPECTIVE N.T.S



COLOUR PERSPECTIVE N.T.S

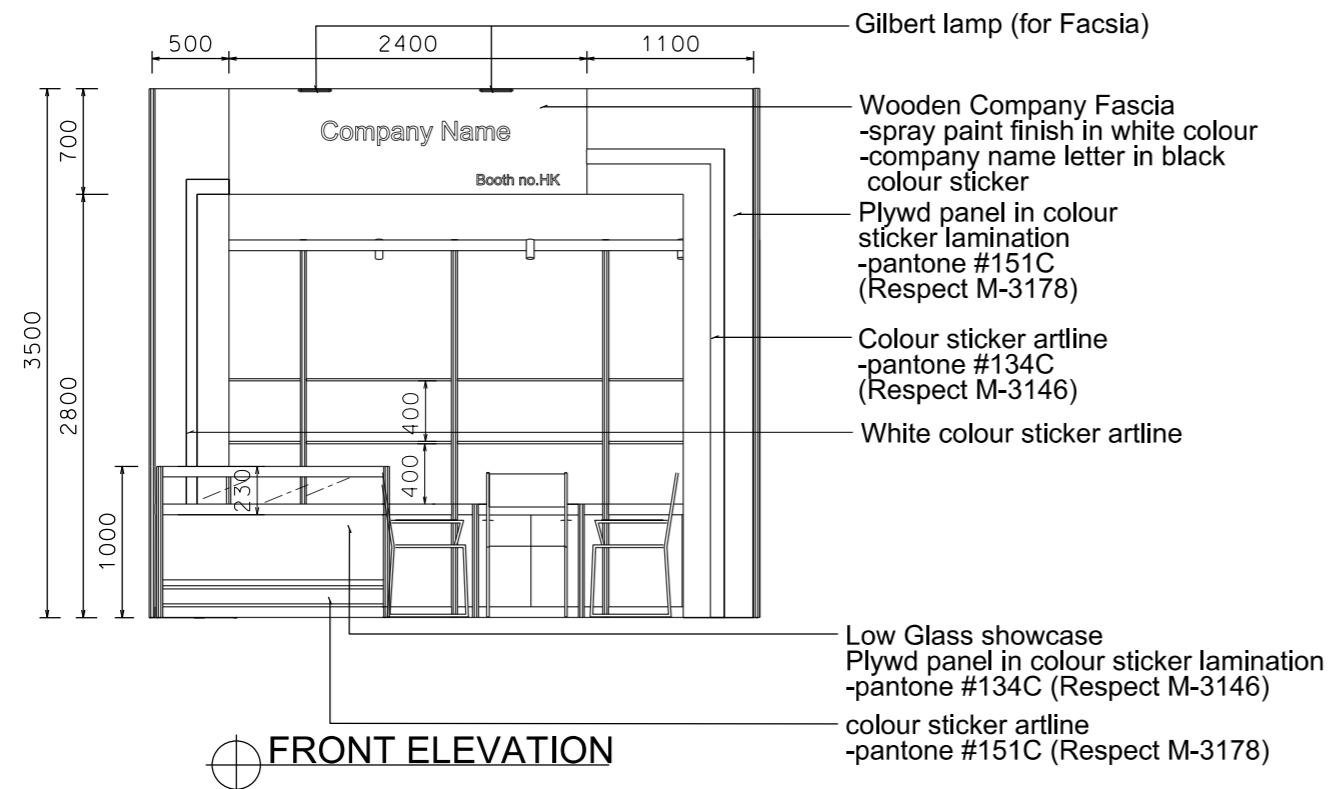

FRONT ELEVATION

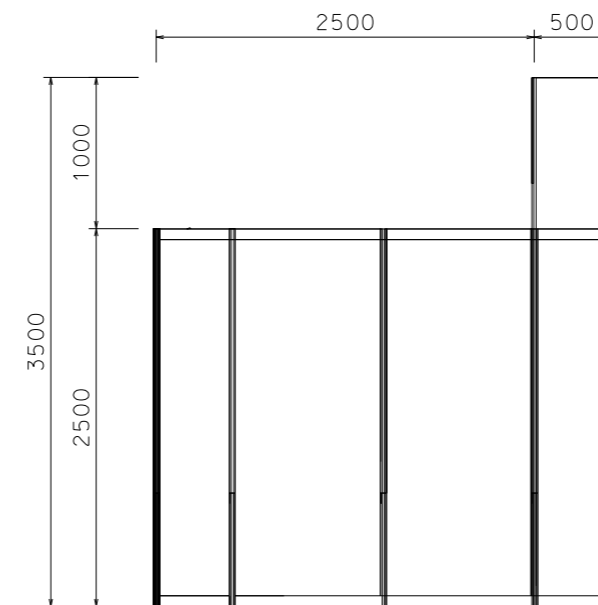

SIDE VIEW

BOOTH SPECIFICATION		QTY
	Front table showcase (1.5m W x 0.5mD x 1mH)	1
	Lockable cabinet (1mL x 0.5mD x 0.75mH)	4
	Glass shelf (flat) (1mL x 0.3mD)	8
	Square meeting table (0.7m X 0.7m x 0.75mH)	1
	Black leather chair	3
	Longarmed spotlight w/23 watt energy saving lamp (yellow)	6
	150W Gilbert lamp (for fascia)	2
	500w Square pin power socket	1
	Ceiling beam	4m

FILE PATH - L:\Local Fair Premium Booth 2011\OP-B-layout\OP-B-2dlayout.dgn



NOTES UNLESS OTHERWISE SPECIFIED ALL DIMENSIONS ARE IN MM.

.....
.....
.....

.....
.....
.....

REVISION
07-01-2009
21-01-2009
03-02-2009
17-02-2009
11-09-2009
22-09-2009
14/08/2012

DATE: 14/08/2012
SCALE: 1 : 50 (A3)
DRAWN BY: ..
CHECKED BY:

TITLE
Premium Booth OP-B-12

PROJECT
PREMIUM BOOTH 4m x 3m
DATE: XXXXXXXX

SHEET
OP-B-01